

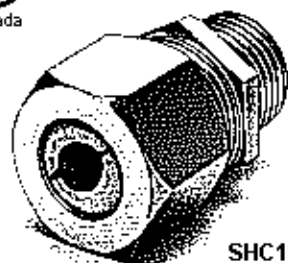

UL Listed and CSA Certified



SHC1022SS

Dimensions = mm

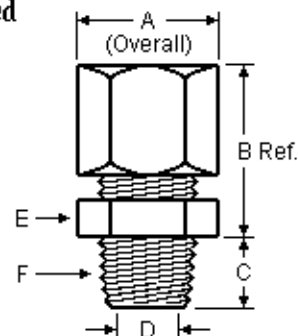

Stainless steel cord connectors provide superior strength and corrosion resistance for industrial and military applications. They are machined from 300 series stainless steel and come in 1/4" through 1" NPT hube sizes. IP66 suitability when used with optional metal clad O-ring. For hub sizes 1/4" and 3/8" and further connectors or optional O-rings, please request.

Catalog No.	NPT Hub	Cord Dia.	Form	Code	A Flats		B	C	D \varnothing	E Flats	
SHC1020SS	1/2"	3.2- 4.7	F2	Orange	33.0	28.7	27.9	13.7	16.0	29.5	25.4
SHC1021SS	1/2"	4.7- 6.3	F2	Red	33.0	28.7	27.9	13.7	16.0	29.5	25.4
SHC1022SS	1/2"	6.3- 9.7	F2	White	33.0	28.7	27.9	13.7	16.0	29.5	25.4
SHC1023SS	1/2"	9.7-12.7	F2	Blue	33.0	28.7	27.9	13.7	16.0	29.5	25.4
SHC1024SS	1/2"	12.7-15.9	F2	Brown	33.0	28.7	27.9	13.7	16.0	29.5	25.4
SHC1035SS	3/4"	9.5-12.7	F3	Blue	40.4	35.1	33.0	14.2	20.6	36.6	31.7
SHC1036SS	3/4"	12.7-15.9	F3	Brown	40.4	35.1	33.0	14.2	20.6	36.6	31.7
SHC1037SS	3/4"	15.9-19.0	F3	Yellow	40.4	35.1	33.0	14.2	20.6	36.6	31.7
SHC1042SS	1"	19.0-22.2	F4	Purple	51.3	44.4	35.6	17.8	26.2	47.8	41.4
SHC1043SS	1"	22.2-25.4	F4	Gray	51.3	44.4	35.6	17.8	26.2	47.8	41.4