

Midget Fuses

Supplementary Overcurrent Protection

KLK Fuses Fast-Acting • 600 VAC



Fast-acting, high-interrupting capacity, current-limiting type fuse. Especially suited for control circuits, street lighting, H.I.D. lighting, computers, and other applications without high in-rush currents.

Voltage Rating: 600 Volts AC
500 Volts DC

Interrupting Rating: UL Listed 100,000 amperes rms symmetrical
(Capable of 200,000 amperes)

Dimensions: $1\frac{3}{32}$ " x $1\frac{1}{2}$ "

Example part number (series & amperage): **KLK 1 $\frac{1}{2}$**

Ampere Ratings:

$\frac{1}{10}$	1	5	15
$\frac{1}{8}$	$1\frac{1}{2}$	6	20
$\frac{2}{10}$	2	7	25
$\frac{1}{4}$	$2\frac{1}{2}$	8	30
$\frac{3}{10}$	3	9	
$\frac{1}{2}$	$3\frac{1}{2}$	10	
$\frac{3}{4}$	4	12	

Approvals: Standard 248-14
UL Listed 3/10-30A (File No: E10480)
CSA Certified 3/10-30A (File No: LR29862)
Versions available to meet
MIL-F-5160/60, QPL F60C:
Contact Factory.

KLKD Fuses Fast-Acting • 600 VAC/DC



Fast acting, high interrupting capacity, current-limiting type fuse. Especially suited for DC control circuits, street lighting, H.I.D. lighting, computers, and other applications.

Voltage Rating: 600 Volts AC/DC

Interrupting Rating: AC: 100,000 amperes rms symmetrical;
DC: 10,000 amperes

Dimensions: $1\frac{3}{32}$ " x $1\frac{1}{2}$ "

Example part number (series & amperage): **KLKD 30**

Ampere Ratings:

$\frac{1}{10}$	1	5	15
$\frac{1}{8}$	$1\frac{1}{2}$	6	20
$\frac{2}{10}$	2	7	25
$\frac{1}{4}$	$2\frac{1}{2}$	8	30
$\frac{3}{10}$	3	9	
$\frac{1}{2}$	$3\frac{1}{2}$	10	
$\frac{3}{4}$	4	12	

Approvals: Standard 248-14
UL Listed 3/10-30A (File No: E10480)
CSA Certified 3/10-30A (File No: LR29862)

FLM Fuses Time-Delay • 250 VAC



Use FLM 250 volt time-delay fuses to protect control circuit transformers, solenoids, and other circuits with high in-rush currents. Excellent for supplemental protection of small motors. For motor branch circuit protection, Refer to Class CC fuses.

Voltage Rating: 125 Volts AC
125 Volts DC self-certified @ 10KA

Interrupting Rating: AC: 10,000 amperes rms symmetrical.

Dimensions: $1\frac{3}{32}$ " x $1\frac{1}{2}$ "

Example part number (series & amperage): **FLM 15**

Ampere Ratings:

$\frac{1}{10}$	$1\frac{1}{8}$	3	8
$\frac{15}{100}$	$1\frac{1}{4}$	$3\frac{2}{10}$	9
$\frac{2}{10}$	$1\frac{4}{10}$	$3\frac{1}{2}$	10
$\frac{1}{4}$	$1\frac{1}{2}$	4	12
$\frac{3}{10}$	$1\frac{6}{10}$	$4\frac{1}{2}$	15
$\frac{4}{10}$	$1\frac{8}{10}$	5	20
$\frac{1}{2}$	2	$5\frac{6}{10}$	25
$\frac{6}{10}$	$2\frac{1}{4}$	6	30
$\frac{8}{10}$	$2\frac{1}{2}$	$6\frac{1}{4}$	
1	$2\frac{8}{10}$	7	

Approvals: Standard 248-14
UL Listed (File No: E10480)
CSA Certified (File No: LR29862)

Recommended Fuse Blocks

L60030M and LPSM series. Refer to the Blocks & Holders section of this catalog for additional information.

Midget Fuses

Supplementary Overcurrent Protection

FLQ Fuses Time-Delay • 500 VAC



These 500 volt time-delay fuses provide excellent supplemental protection of control power transformers, solenoids, and circuits with high inrush currents. UL and CSA 500 volt ratings permit use on 480 volt circuits. FLQ fuses also provide supplemental protection to small motors. For motor branch circuit protection, refer to Class CC fuses.

Voltage Rating: 500 Volts AC
300 Volts DC self-certified @ 10KA
Interrupting Rating: 10,000 amperes rms
symmetrical
Dimensions: $1\frac{3}{32}'' \times 1\frac{1}{2}''$
Example part number (series & amperage): **FLQ 1/2**

Ampere Ratings:

$\frac{1}{10}$	$\frac{8}{10}$	$3\frac{3}{10}$	9
$\frac{1}{8}$	1	$3\frac{1}{2}$	10
$\frac{15}{100}$	$1\frac{1}{8}$	4	12
$\frac{3}{16}$	$1\frac{1}{4}$	$4\frac{1}{2}$	14
$\frac{2}{10}$	$1\frac{1}{2}$	5	15
$\frac{1}{4}$	$1\frac{6}{10}$	$5\frac{6}{10}$	20
$\frac{3}{10}$	2	6	25
$\frac{4}{10}$	$2\frac{1}{4}$	$6\frac{1}{4}$	30
$\frac{1}{2}$	$2\frac{1}{2}$	7	
$\frac{6}{10}$	3	8	

Approvals: Standard 248-14
UL Listed (File No: E10480)
CSA Certified (File No: LR29862)

BLN Fuses Fast-Acting • 250 VAC



Fiber tube, 250 volt BLN fuses provide low-cost protection for military applications and control circuits.

Voltage Rating: 250 Volts AC
Interrupting Rating: 10,000 amperes rms
symmetrical
Dimensions: $1\frac{3}{32}'' \times 1\frac{1}{2}''$
Example part number (series & amperage): **BLN 30**

Ampere Ratings:

1	4	8	15	30
2	5	10	20	
3	6	12	25	

Approvals: Standard 248-14
UL Listed (File No: E10480)
CSA Certified (File No: LR29862)
Versions available to meet MIL-F-15160/9,
QPL F09A: Contact Factory

BLF Fuses Fast-Acting • 125/250 VAC



Laminated tube BLF fuses are the lowest price midget fuse. They are suitable for control circuit and instrument protection in dry locations.

Voltage Ratings: 250 Volts AC: $\frac{1}{2}$ – 15 amperes;
125 Volts AC: 20 – 30 amperes
Interrupting Rating: 10,000 amperes rms
symmetrical
Dimensions: $1\frac{3}{32}'' \times 1\frac{1}{2}''$
Example part number (series & amperage): **BLF 5**

Ampere Ratings:

$\frac{1}{2}$	3	7	15
1	4	8	20
$1\frac{1}{2}$	5	9	25
2	6	10	30
$2\frac{1}{2}$	$6\frac{1}{4}$	12	

Approvals: Standard 248-14
UL Listed (File No: E10480)
CSA Certified (File No: LR29862)

Recommended Fuse Blocks

L60030M and LPSM series. Refer to the Blocks & Holders section of this catalog for additional information.

Midget Fuses

Supplementary Overcurrent Protection

BLS Fuses

Fast-Acting • 250/600 VAC



BLS fuses are 1³/₈" long in contrast to other midget fuses which are 1¹/₂". They provide space saving, low cost protection to street lighting, metering, control and electronic circuits.

Voltage Rating: 600 Volts AC: 2¹/₁₀ – 5 amperes;
250 Volts AC: 6 – 10 amperes

Interrupting Rating: 10,000 amperes rms
symmetrical

Dimensions: 1³/₃₂" x 1³/₈"

Example part number (series & amperage): **BLS 10**

Ampere Ratings:

2 ¹ / ₁₀	1	3	8
4 ¹ / ₁₀	1 ¹ / ₂	4	10
1 ¹ / ₂	1 ⁶ / ₁₀	5	
3 ¹ / ₄	1 ⁸ / ₁₀	6	
8 ¹ / ₁₀	2	7	

Approvals: Standard 248-14
UL Listed 2¹/₁₀-10 Amps (File No: E10480)
CSA Certified 1¹/₂ – 5 Amps
(File No: LR29862)

FLA Fuses

Time-Delay • 125 VAC



FLA fuses are 125 volt, pin-indicating time-delay fuses for protection of control circuit transformers, solenoids, and other circuits with high in-rush currents. Metal indicating pin pops-out when fuse opens, giving visual indication of blown fuse. Use FLA fuses in conjunction with special fuseblocks to operate mechanical signal switches or energize alarm circuits. Fuses rated 12 amperes and above have dual-tube construction.

Voltage Rating: 125 Volts AC

Interrupting Rating: 10,000 amperes rms
symmetrical

Dimensions: 1³/₃₂" x 1¹/₂"

Example part number (series & amperage): **FLA 15**

* *Note: Dual tube construction*

Ampere Ratings:

1 ¹ / ₁₀	1 ¹ / ₈	3	8
1 ⁵ / ₁₀₀	1 ¹ / ₄	3 ² / ₁₀	10
2 ¹ / ₁₀	1 ⁴ / ₁₀	3 ¹ / ₂	12*
1 ¹ / ₄	1 ¹ / ₂	4	15*
3 ¹ / ₁₀	1 ⁶ / ₁₀	4 ¹ / ₂	20*
4 ¹ / ₁₀	1 ⁸ / ₁₀	5	25*
1 ¹ / ₂	2	5 ⁶ / ₁₀	30*
6 ¹ / ₁₀	2 ¹ / ₄	6	
8 ¹ / ₁₀	2 ¹ / ₂	6 ¹ / ₄	
1	2 ⁸ / ₁₀	7	

Approvals: Standard 248-14
UL Listed (File No: E10480)
CSA Certification Pending

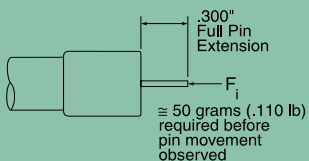

Recommended Fuse Blocks

L60030M and LPSM series. Refer to the Blocks & Holders section of this catalog for additional information.

Midget Fuses

Supplementary Overcurrent Protection

KLQ Series Fuses



The Littelfuse KLQ series is designed to protect gaseous vapor fixtures, HID ballasts, and other electronic and lighting circuits. The KLQ is the same physical size as the Littelfuse BLS, but has more time-delay to handle transient and in-rush currents.

Voltage Rating: 600 VAC
Interrupting Rating: 10,000 amperes
Approvals: Standard 248-14 UL Listed (File No: E10480)
Dimensions: $1\frac{3}{32}$ " x $1\frac{3}{8}$ "

Ampere Ratings:

1	2	5
$1\frac{6}{10}$	3	6

Recommended Fuse Blocks:

L60030M Series. Refer to the Blocks & Holders section of this catalog for additional information.

Ordering Information:

Example catalog number: KLQ005
 Example system number: 0KLQ005.T

FLU Series Fuses



The Littelfuse FLU series is designed specifically for the protection of multimeters. The 1000 VAC/VDC rating also makes the FLU ideal for a variety of other applications.

Voltage Rating: 1000 VAC/VDC
Interrupting Rating: $44/100$ A: 10kA
 11A: 20kA
Ampere Range: FLU $44/100$ = 1A and FLU 11 = 15A
Approvals: UL Recognized under the components program. (File No: E10480)
 CSA Certified (File No: LR29862)
Dimensions: $44/100$ A: $1\frac{3}{32}$ " x $1\frac{3}{8}$ "
 11A: $1\frac{3}{32}$ " x $1\frac{1}{2}$ "

Ordering Information

Example catalog number: FLU011
 Example system number: 0FLU011.T

LNNB "Dummy" Fuse

Also known as a "neutral", the LNNB is actually not a fuse. It is the same physical size as a standard Midget fuse. The LNNB001 is a hollow body design for use with standard fuse clips. The LNNB002 is a solid body design for use with LEB/LEX series inline style fuse holders.

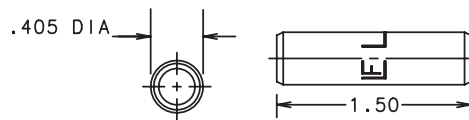

LNNB001

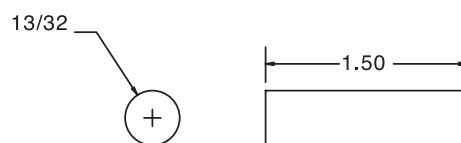

LNNB002

Specifications

Dimensions: $1\frac{3}{32}$ " x $1\frac{1}{2}$ "

Ordering Information

Example catalog number: LNNB001
 Example system number: LNNB0001Z

Example catalog number: LNNB002
 Example system number: LNNB0002Z

Midget Fuses

Supplementary Overcurrent Protection

