

Snap-In Socket Outlets, according to SEV Standards

Switzerland System

Snap-In Socket Outlets according to SEV Standards



Specifications

- SEV 6535 Type 13, 10A / 250V
- SEV 5934-1 Type 23, 16A / 250V
- Screwless Terminals
- Thermoplastic Housing
- Snap-In Mounting for 4 mm Panels
(Special mounting e.g. 2 mm depending on quantity.)



SEV1112



SEV1122

Catalog Number	Device Color*	Ratings Ampere/Voltage	SEV Type	SEV Reference and Standard	Weight each (net)	Standard Pack VPE / Packed
SEV1112	Black	10A, 250V AC	Type 13	13-601 SEV 6535	19 g	2000/200 ea
SEV1122	Black	16A, 250V AC	Type 23	13-602 SEV 5934-1	18 g	2000/200 ea

*Standard Color: Black

Further colors available depending on quantity (e.g. white, orange, red, grey etc.).

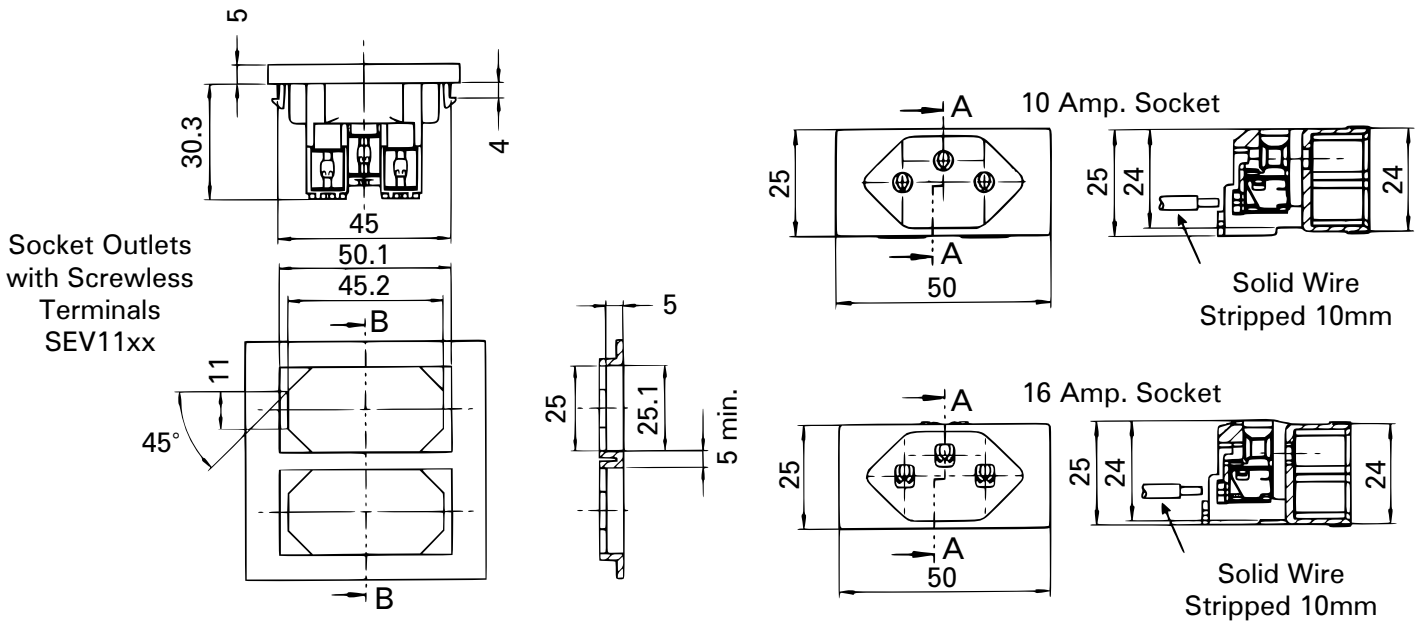

Specifications and dimensions are nominal and subject to change without notice. Dimensions in mm.