

## RIGID AND IMC FITTINGS STEEL - LOCKNUTS



### Application

- For use in dry locations on threaded rigid/IMC conduit to secure conduit to a box or enclosure

### Product Features

- All steel construction insures mechanical protection
- Zinc electro plated for corrosion protection

### Compliances

-  - Standard 514B
-  - C22.2 #18 (3/8"-4" trade sizes)

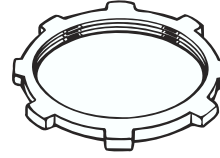

LOCKNUTS  
STEEL

### ORDERING INFORMATION - DIMENSIONS

LOCKNUTS - STEEL				
CATALOG NUMBER	TRADE SIZE	UNIT CTN. QTY.	SHIP CTN. QTY.	UPC BAR CODE
1001	3/8"	100	1000	—
1002	1/2"	100	1000	—
1003	3/4"	100	1000	—
1004	1"	—	100	—
1005	1-1/4"	—	50	—
1006	1-1/2"	—	50	—
1008	2"	—	50	—
1010	2-1/2"	—	30	—
1012	3"	—	25	—
1014	3-1/2"	—	15	—
1016	4"	—	10	—
1020	5"	—	8	—
1024	6"	—	8	—

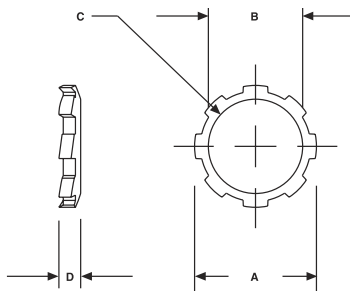

A = O.D.  
B = I.D.  
C = Thread size  
D = Thickness

DIMENSIONS				
CATALOG NUMBER	A	B	C THD. SPEC.	D
1001	1"	39/64"	3/8-18 NPT	5/32"
1002	1-1/8"	49/64"	1/2-14 NPT	5/32"
1003	1-3/8"	31/32"	3/4-14 NPT	11/64"
1004	1-45/64"	1-15/64"	1-11-1/2 NPT	13/64"
1005	2-1/16"	1-37/64"	1-1/4-11-1/2 NPT	7/32"
1006	2-3/8"	1-13/16"	1-1/2-11-1/2 NPT	7/32"
1008	2-57/64"	2-9/32"	2-11-1/2 NPT	15/64"
1010	3-9/16"	2-3/4"	2-1/2-8 NPT	3/8"
1012	4-1/4"	3-3/8"	3-8 NPT	3/8"
1014	4-13/16"	3-7/8"	3-1/2-8 NPT	3/8"
1016	5-13/32"	4-3/8"	4-8 NPT	3/8"
1020	6-43/64"	5-7/16"	5-8 NPT	1/2"
1024	7-15/16"	6-1/2"	6-8 NPT	9/16"