

FEATURES & SPECIFICATIONS

INTENDED USE

Ideal where high brightness and good illumination levels are required such as retail, light industrial and warehouses.

ATTRIBUTES

Fixture can be assembled with snap together components and requires no tools. Available in one lamp or two lamp configuration.

CONSTRUCTION

Heavy-duty channel, die-formed from code-gauge steel. Sturdy channel cover secured by captive quarter-turn latch for easy access to wireway.

Combination endplate/channel connector furnished with each fixture.

FINISH

Five-stage iron phosphate pretreatment ensures superior paint adhesion and rust resistance. Painted parts finished with high-gloss, baked white enamel.

ELECTRICAL SYSTEM

Thermally protected, resetting, Class P, UL Listed and CSA Certified ballast is standard. Sound rating depends on lamp/ballast combination.

AWM, TFN, THHN wire throughout, rated for required temperatures.

INSTALLATION

For unit or row installations, surface or suspended mounting.

LISTING

UL listed to US and Canadian safety standards. Optional: Mexico NOM.

WARRANTY

Guaranteed for one year against mechanical defects in manufacture.

Specifications subject to change without notice.

General-Purpose Strip

C

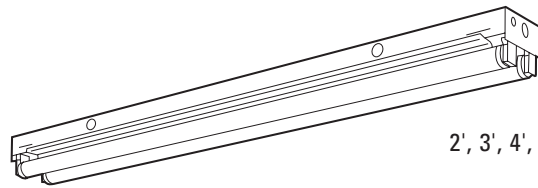

2', 3', 4', 6' or 8' length
1 or 2 lamps

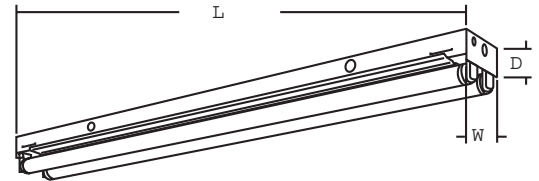

Specifications

Length:	24" (610)
	36" (914)
	48" (1219)
	72" (1829)
	96" (2438)
Width:	4-3/8" (111)
Fixture Depth:	2-1/16" (52)

All dimensions are inches (millimeters).

ORDERING INFORMATION

For shortest lead times, configure product using **standard options (shown in bold)**.

Example: C 2 32 MVOLT GEB10IS

C				
Series	Lamp type	Voltage	Options	
C General-purpose strip		MVOLT^{1,2}		
For tandem double-length unit, add prefix T. Example: TC	T8	120	GEB Electronic ballasts, <math>\leq 20\%</math> THD³	
	17 17W T8 (24")	277	GEB10IS Electronic ballasts, <math>\leq 10\%</math> THD instant start^{1,2}	
	25 25W T8 (36")	347	GEB10RS T8 electronic ballast, $\leq 10\%$ THD, rapid start	
	32 32W T8 (48")	Others available.	BILP High-efficiency ballast, .78bf (low), instant start	
	96T8 59W T8 slimline (96")		BINP T8 high-performance ballast, .88 bf (normal), instant start	
	T12 Slimline		BIHP T8 high-performance ballast, 1.20 bf (high), instant start ⁴	
	36 30W slimline (36")		1/4 One four-lamp ballast ⁵	
	48 38W slimline (48")		EL Emergency battery pack (nominal 300 lumens)	
	72 55W slimline (72")		GLR Internal fast-blow fuse (add X for external) ⁶	
	96 75W slimline (96")		GMF Internal slow-blow fuse (add X for external) ⁶	
Number of lamps			PLR_ Plug-in wiring; specify 1, 2 or 3 branch circuits and hot wires (A = Black, B = Red, C = Blue, AB or AC)	
1			TILW Tandem in-line wiring	
2			CW Cold-weather ballast; 0°F starting temp	
Not included.			CSA CSA Certified (only required for 347V)	
			NOM NOM Certified	
Accessories				
Order as separate catalog numbers.				
SQ_ Swivel-stem hanger (specify length in 2" increments).				
1B Ceiling spacer (adjusts from 1-1/2" to 2-1/2" from ceiling).				
CONLGC 12" screw-on channel connector.				
WG CUN Wireguard, 4' white. ⁵				
HC36 Chain hangers (1 pair, 36" long).				
HRC Hooker® T-bar hanger (flush to ceiling).				
HRC1 Hooker® T-bar hanger (1-1/2" from ceiling).				
WG CSMR Wireguard, 4' white for symmetric reflector. ⁵				
WG CASR Wireguard, 4' white for asymmetric reflector. ⁵				
CSMR48 Symmetric reflector, 4' white, 7" aperture. ⁵				
CASR48 Asymmetric reflector, 4' white, 5-3/4" wide. ⁵				

NOTES:

- MVOLT standard for 120-277V applications, 50-60 mhz operation. Some options require voltage specified.
- T8 lamps only.
- Slimline lamps only.
- Not available in 347V.
- Not available in slimline.
- Specify voltage.
- Order two for 8' fixtures.

C General-Purpose Strip

MOUNTING DATA

For unit or row installation, surface or suspended mounting.
 Unit installation — Minimum of two hangers required.
 Row installation — Two hangers per channel required. One per fixture plus one per row if CONLGC installed.
 Hooker® (HRC) and HC Hangers — Minimum two per channel (unit and row)

See ACCESSORIES below for hanging devices.

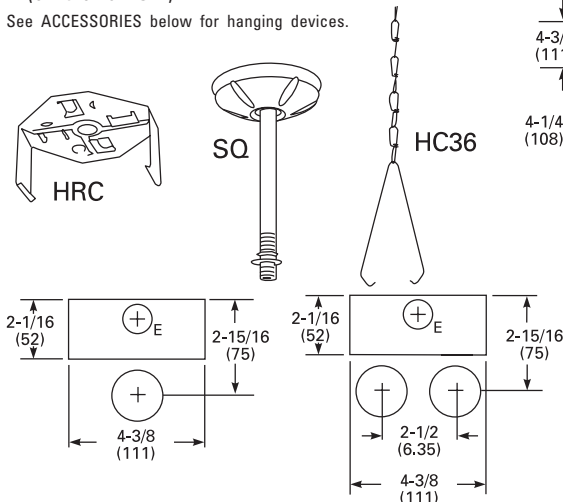

D = 11/16 (17) Dia.K.O.
 E = 7/8 (22) Dia.K.O.
 F = 1-1/4 (32) Dia.K.O.
 H = 2 (51) Dia.K.O.

DIMENSIONS

Inches (millimeters). Subject to change without notice.
 48", 72" and 96" have only two 7/8" K.O.'s 6" from each end
 24" and 36" have only two 7/8" K.O.'s 3-1/4" from each end

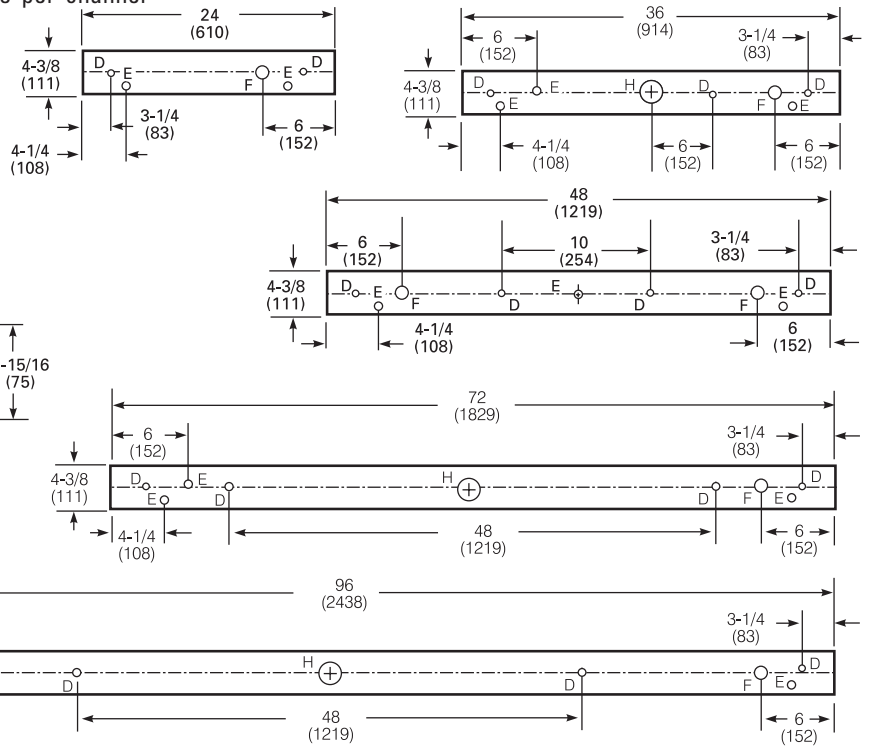

PHOTOMETRICS

Calculated using the zonal cavity method in accordance with IESNA LM41 procedure. Floor reflectances are 20%. Lamp configurations shown are typical. All data based on 25°C. Full photometric data on these and other configurations available upon request.

C 2 96

TEST NO: LTL 18310
 LUMENS PER LAMP: 6300

RCR	pf	pc	Coefficients of Utilization									
			20%			50%			80%			
			50%	30%	10%	50%	30%	10%	50%	30%	10%	
0	103	103	103	98	98	98	90	90	90	86	82	78
1	74	67	61	82	78	74	75	72	69	74	67	61
2	64	56	49	61	54	48	56	49	44	61	54	48
3	56	47	41	53	46	40	49	42	37	56	47	41
4	49	41	35	47	39	34	43	37	31	49	41	35
5	44	36	30	42	34	29	39	32	27	44	36	30
6	40	32	26	38	30	25	35	28	24	40	32	26
7	36	28	23	35	27	22	32	25	21	36	28	23
8	33	25	20	32	25	20	29	23	19	33	25	20
9	30	23	18	29	22	18	27	21	17	30	23	18
10												

C 2 32

TEST NO: LTL 5181
 LUMENS PER LAMP: 2900

RCR	pf	pc	pw	Coefficients of Utilization								
				20%			50%			80%		
				50%	30%	10%	50%	30%	10%	50%	30%	10%
0	106	106	106	102	102	102	93	93	93	89	84	79
1	76	68	62	72	66	60	66	61	56	76	68	62
2	65	57	50	62	55	49	57	51	45	65	57	50
3	57	48	42	55	47	40	50	43	38	57	48	42
4	51	42	35	48	40	34	44	37	32	51	42	35
5	45	36	30	43	35	29	40	33	28	45	36	30
6	41	32	26	39	31	25	36	29	24	41	32	26
7	37	29	23	35	28	22	33	26	21	37	29	23
8	34	26	20	32	25	20	30	23	19	34	26	20
9	31	23	18	30	23	18	28	21	17	31	23	18
10												

Zonal Lumen Summary

Zone	Lumens	% Lamp	% Fixture
0° - 30°	1785.8	14.2	15.7
0° - 40°	3042.4	24.1	26.8
0° - 60°	5944.0	47.2	52.3
0° - 90°	9027.5	71.6	79.4
90° - 180°	2341.8	18.6	20.6
0° - 180°	11369.4	90.2	100.0

Zonal Lumen Summary

Zone	Lumens	% Lamp	% Fixture
0° - 30°	842.1	14.5	15.6
0° - 40°	1435.8	24.8	26.7
0° - 60°	2810.1	48.4	52.2
0° - 90°	4362.5	75.2	81.0
90° - 180°	1021.0	17.6	19.0
0° - 180°	5383.6	92.8	100.0

Energy (Calculated in accordance with NEMA standard LE-5)

LER.FL	ANNUAL ENERGY COST*	LAMP DESCRIPTION	LAMP LUMENS	BALLAST FACTOR	WATTS
86.2	\$2.79	(2)T8 F32	2900	.88	55

* Comparative yearly lighting energy cost per 1000 lumens

Energy (Calculated in accordance with NEMA standard LE-5)

ORDERING INFORMATION	LER.FL	ANNUAL ENERGY COST*	LAMP DESCRIPTION	LAMP LUMENS	BALLAST FACTOR	WATTS
C 2 32 MVOLT GEB10IS	77.6	\$3.09	F32T8/735	2800	.88	59
C 2 32 MVOLT BILP	93.6	\$2.56	F32T8/835/HT8	3100	.78	48

* Comparative yearly lighting energy cost per 1000 lumens