



## Single SCHUKO Outlets for Special Applications

- **5831-series** screw mount outlets
- **5841-series** snap-in standard outlets
- **5843-series** snap-in fused outlets
- Round and square units available
- Versions for medical use available
- Colours: white, light grey, green, orange or customer colours on special request
- Snap-in outlets available for 0.7mm to 6.5mm panel mounting
- Fused outlets with 1.15 to 10 Amp. fast acting or time delay fuse on request

### 5831-series

2-poles+Earth, 16 A, 250 V, with thermosetting plastic base, without fuses, not for new equipment, but only suitable for repairs and retrofitting in medical rooms, Colour: white, light grey, green, orange, with rectangular hinged lid, with screw-type terminal up to 2.5 mm<sup>2</sup>, VDE sign, T 150.

### 5841-series

2-poles+Earth, 10/16 A, 250 V, with thermosetting plastic base, Optionally screw terminal or flat termination clamps, Colour of pressed parts optional, Latch holding the hinged cover open is supplied on request, Clamping ranges with snap-in mounting, Types: 0.7-1.8 mm, 1.8-3.2 mm, 3.0-6.5 mm, VDE sign, T 150, TNO design on request.

### 5843-series

2-poles+Earth, 10 A, 250 V ac, with thermosetting plastic base, with 2 fine-wire fuses, optional fast or time delay from 1.15 to 10 Amps, With screwless plug-in terminals for wire end ferrules, earth screwed, Colour of pressed parts optional, Latch holding the hinged cover open is supplied on request, Clamping ranges with snap-in mounting types: 0.7-1.8 mm, 1.8-3.2 mm, 3.0-6.5 mm, VDE sign, T 150.



# SCHUKO-EINBAUSTECKDOSEN

## FLUSH-TYPE SOCKET OUTLETS

### WITH EARTHING CONTACT

**Reihe 5831** <sup>1) 2)</sup>

- 2-polig + E, 16 A, 250 V  
mit Duroplastsockel
- ohne Sicherungen
- nicht für Neueinrichtungen,  
sondern nur für Reparaturen  
und Nachrüstungen  
in medizinischen Räumen  
geeignet
- Farbe: weiß, hellgrau,  
grün, orange
- mit rechteckigem  
Klappdeckel
- mit Schraubanschluss  
bis 2,5 mm<sup>2</sup>

VDE-Zeichen, T 150

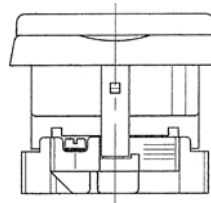

**58310011**  
- weiß

**58310029**  
- hellgrau

- für Installationen in  
medizinischen Räumen  
ohne Sicherungen

**58310052**  
- grün (SV) RAL 6018

**58310094**  
- orange (ZSV) RAL 2004

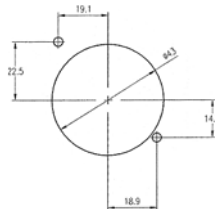
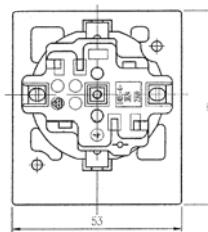

**Reihe 5831 rechteckig**  
- für Schraubbefestigung  
- IP 42, VDE 0470, Teil 1

**Series 5831 square**  
- for screw mounting  
- IP 42, VDE 0470, part 1

**58310011**  
- white

**58310029**  
- light grey

- for installation in  
medical rooms  
without fuses

**58310052**  
- green (SV) RAL 6018

**58310094**  
- orange (ZSV) RAL 2004

**Series 5831** <sup>1) 2)</sup>

- 2-pole + E, 16 A 250 V  
with thermosetting plastic base
- without fuses
- not for new equipment,  
but only suitable for repairs  
and retrofitting in  
medical rooms
- Colour: white, light  
grey, green, orange
- with rectangular  
hinged lid
- with screw-type  
terminal up to 2.5 mm<sup>2</sup>

VDE sign, T 150

1) Anschlussklemmen nach VDE 0620 als Verbindungsklemmen approbiert. / Terminals according to VDE 0620 approved as connecting terminal units.  
 2) Nur für Geräteeinbau. / Only for fitting in appliance.

## SCHUKO-EINBAUSTECKDOSEN FLUSH-TYPE SOCKET OUTLETS WITH EARTHING CONTACT

### Reihe 5841

- 2-polig + E, 10/16 A, 250 V mit Duroplastsockel
- wahlweise Schraubklemmen oder Flachverbinderklemmen
- Farbe der Preßteile nach Kundenwunsch
- auf Wunsch Klappdeckel-arretierung in Offenstellung
- Klemmbereiche bei Schnappbefestigung 0,7 - 1,8 mm, 1,8 - 3,2 mm, 3,0 - 6,5 mm

VDE-Zeichen, T 150

(S) (NL) (N)

TNO-Ausführungen auf Anfrage

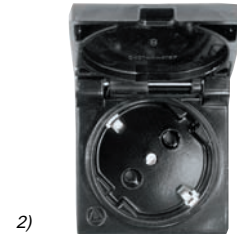

2)

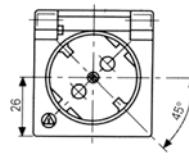
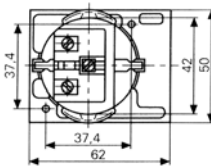
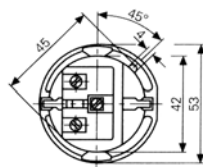
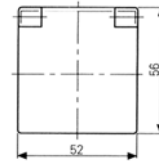
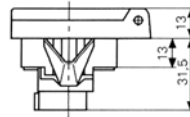
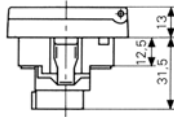

Ansicht ohne Klappdeckel  
View without hinged cover

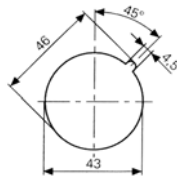

bei entsprechendem Einbau 1)  
with appropriate mounting type 1)

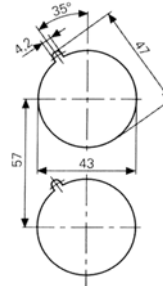
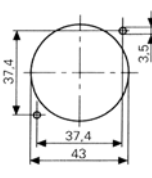

#### 58410... rund

- mit Schnappfedern für Schnellbefestigung
- IP 42, VDE 0470, Teil 1

#### 58410... round

- with snap-on springs for quick mounting
- IP 42, VDE 0470, part 1

#### 58411... rechteckig

- mit Schnappfedern für Schnellbefestigung
- für Schraubbefestigung
- IP 42, VDE 0470, Teil 1

#### 58411... square

- with snap-on springs for quick mounting
- for screw mounting
- IP 42, VDE 0470, part 1

#### 584113... rechteckig Sondermodell für Laborkanäle

- mit Schnappfedern für Schnellbefestigung
- IP 42, VDE 0470, Teil 1

#### 584113... square

- Special model for laboratory ducts
- with snap-on springs for quick mounting
- IP 42, VDE 0470, part 1

### Series 5841

- 2-pole + E, 10/16 A, 250 V with thermosetting plastic base
- Optionally screw terminal or flat termination clamps
- Colour of pressed parts optional
- Latch holding the hinged cover open is supplied on request
- Clamping ranges with snap-on mounting types:  
0.7 - 1.8 mm  
1.8 - 3.2 mm  
3.0 - 6.5 mm

VDE sign, T 150

(S) (NL) (N)

TNO design on request

Lagertypen gemäß Sonderliste

1) Moosgummidichtung zur Abdichtung zwischen Gerätewand und Steckdosenoberteil lieferbar unter Nr. 005010855

2) mit Moosgummidichtung IP 44 nach VDE 0789, Teil 100

See special list for bearing types

1) Sponge rubber seal between device wall and socket outlet top available under number 005010855

2) with sponge rubber seal IP 44 acc. to VDE 0789, part 100

## SCHUKO-EINBAUSTECKDOSEN FLUSH-TYPE SOCKET OUTLETS WITH EARTHING CONTACT

### Reihe 5841

- 2-polig + E, 10/16 A, 250 V mit Duroplastssocket
- wahlweise Schraubklemmen oder Flachverbinderklemmen
- Farbe der Preßteile nach Kundenwunsch
- auf Wunsch Klappdeckel-arretierung in Offenstellung
- Klemmbereiche bei Schnappbefestigung  
0,7 - 1,8 mm  
1,8 - 3,2 mm  
3,0 - 6,5 mm

VDE-Zeichen, T 150

(S) (NL) (N)

TNO-Ausführungen auf Anfrage

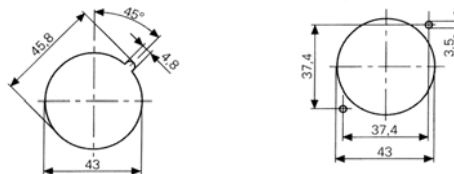
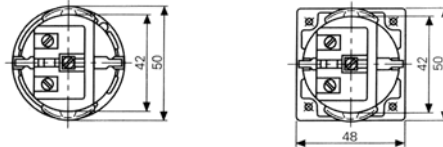

#### 58412... rund

- mit Schnappfedern für Schnellbefestigung
- IP 40, VDE 0470, Teil 1

#### 58412... round

- with snap-on springs for quick mounting
- IP 40, VDE 0470, part 1

#### 58413... rechteckig

- mit Schnappfedern für Schnellbefestigung
- für Schraubbefestigung vier Befestigungslöcher Ø 4,3 mm
- IP 40, VDE 0470, Teil 1

#### 58413... square

- with snap-on springs for quick mounting
- for screw mounting, four holes 4.3 mm
- IP 40, VDE 0470, part 1

### Series 5841

- 2-pole + E, 10/16 A 250 V with thermosetting plastic base
- Optionally screw terminal or flat termination clamps
- Colour of pressed parts optional
- Latch holding the hinged cover open is supplied on request
- Clamping ranges with snap-on mounting types:  
0.7 - 1.8 mm  
1.8 - 3.2 mm  
3.0 - 6.5 mm

VDE sign, T 150

(S) (NL) (N)

TNO design on request

## SCHUKO-EINBAUSTECKDOSEN FLUSH-TYPE SOCKET OUTLETS WITH EARTHING CONTACT

### Reihe 5843

- 2-polig + E, 10 A/250 V~, mit Duroplastsockel
- mit 2 Feinsicherungen wahlweise flinke und träge von 1,15 bis 10 A
- mit schraubenlosen Steckanschlüssen für Aderendhülsen und massive Leiter, Erde geschraubt
- Farbe der Preßteile nach Kundenwunsch
- auf Wunsch Klappdeckelarretierung in Offenstellung
- Klemmbereiche bei Schnappbefestigung 0,7 - 1,8 mm  
1,8 - 3,2 mm  
3,0 - 6,5 mm

VDE-Zeichen, T 150

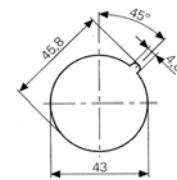
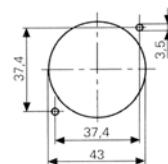
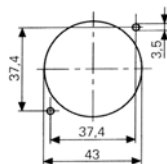
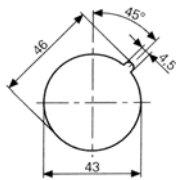
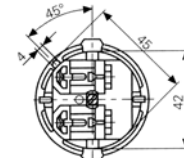
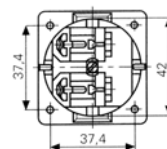
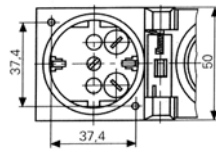
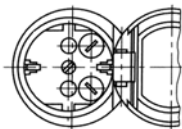
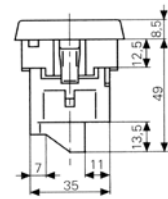
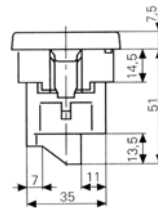
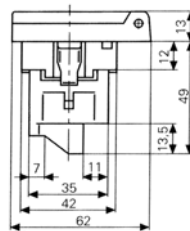
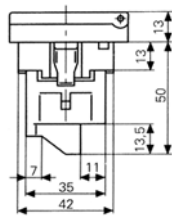

 bei entsprechendem Einbau 1)  
with appropriate mounting type 1)

- 584320.. rund**  
- mit Schnappfedern für Schnellbefestigung  
- IP 42, VDE 0470, Teil 1

- 584321.. rechteckig**  
- mit Schnappfedern für Schnellbefestigung  
- für Schraubbefestigung  
- IP 42, VDE 0470, Teil 1

- 584323.. rechteckig**  
- mit Schnappfedern für Schnellbefestigung  
- für Schraubbefestigung vier Befestigungslöcher Ø 4,3 mm  
- IP 40, VDE 0470, Teil 1

- 584326.. rund**  
- mit Schnappfedern für Schnellbefestigung  
- IP 40, VDE 0470, Teil 1

- 584320.. round**  
- with snap-on springs for quick mounting  
- IP 42, VDE 0470, part 1

- 584321.. square**  
- with snap-on springs for quick mounting  
- for screw mounting  
- IP 42, VDE 0470, part 1

- 584323.. square**  
- with snap-on springs for quick mounting  
- for screw mounting, four holes 4.3 mm  
- IP 40, VDE 0470, part 1

- 584326.. round**  
- with snap-on springs for quick mounting  
- IP 40, VDE 0470, part 1

### Series 5843

- 2-pole + E, 10A/250 VAC, with thermosetting plastic base
- with 2 fine-wire fuses optional fast and inert from 1,15 to 10 A
- With screwless plug-on terminals for wire end ferrules, earth screwed
- Colour of pressed parts optional
- Latch holding the hinged cover open is supplied on request
- Clamping ranges with snap-on mounting types: 0.7 - 1.8 mm  
1.8 - 3.2 mm  
3.0 - 6.5 mm

VDE sign, T 150

1) Moosgummidichtung zur Abdichtung zwischen Gerätewand und Steckdosenoberteil lieferbar unter Nr. 005010855  
1) Sponge rubber seal between device wall and socket outlet top available under number 005010855